

FASE 2

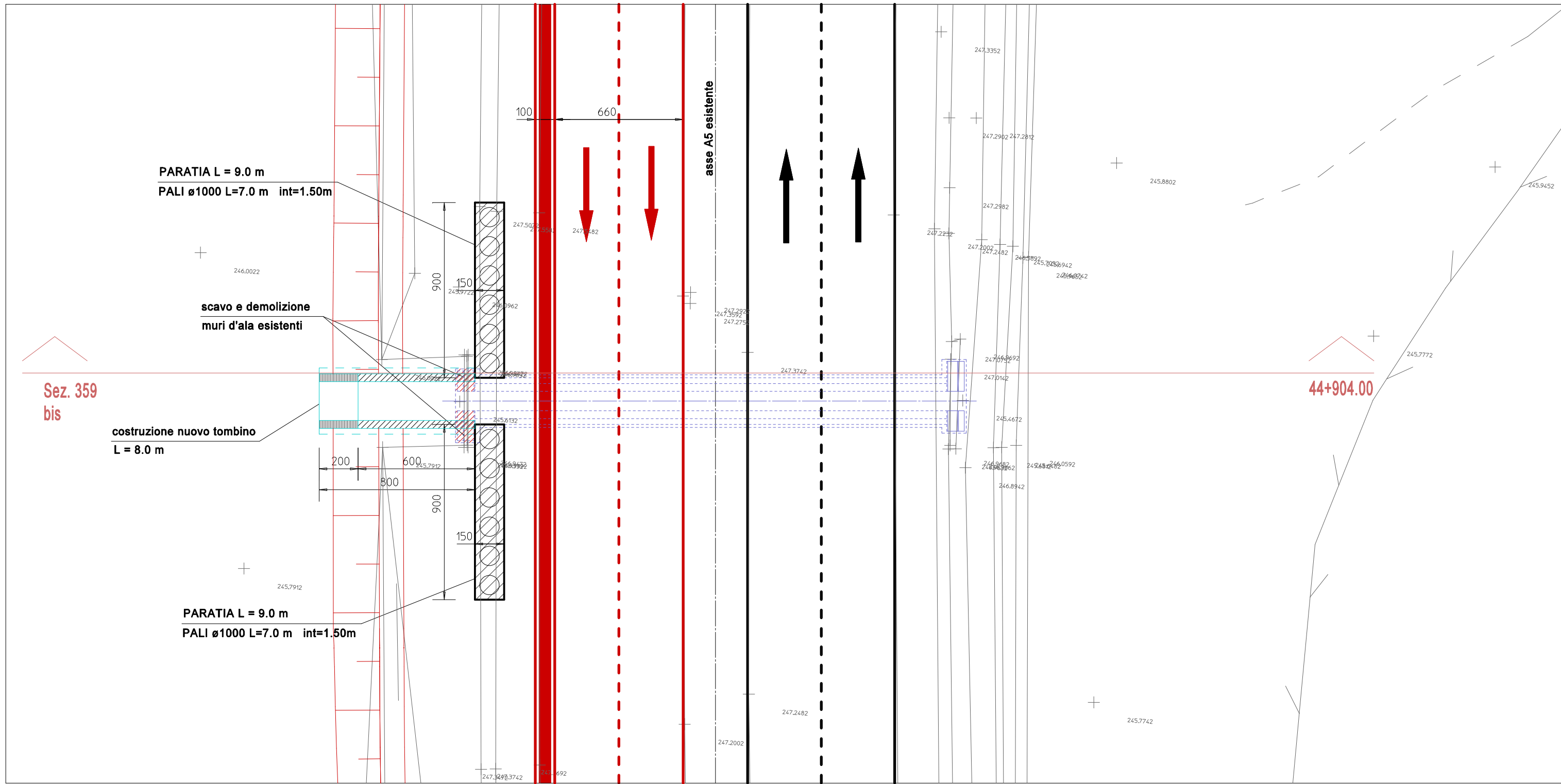

FASE 4

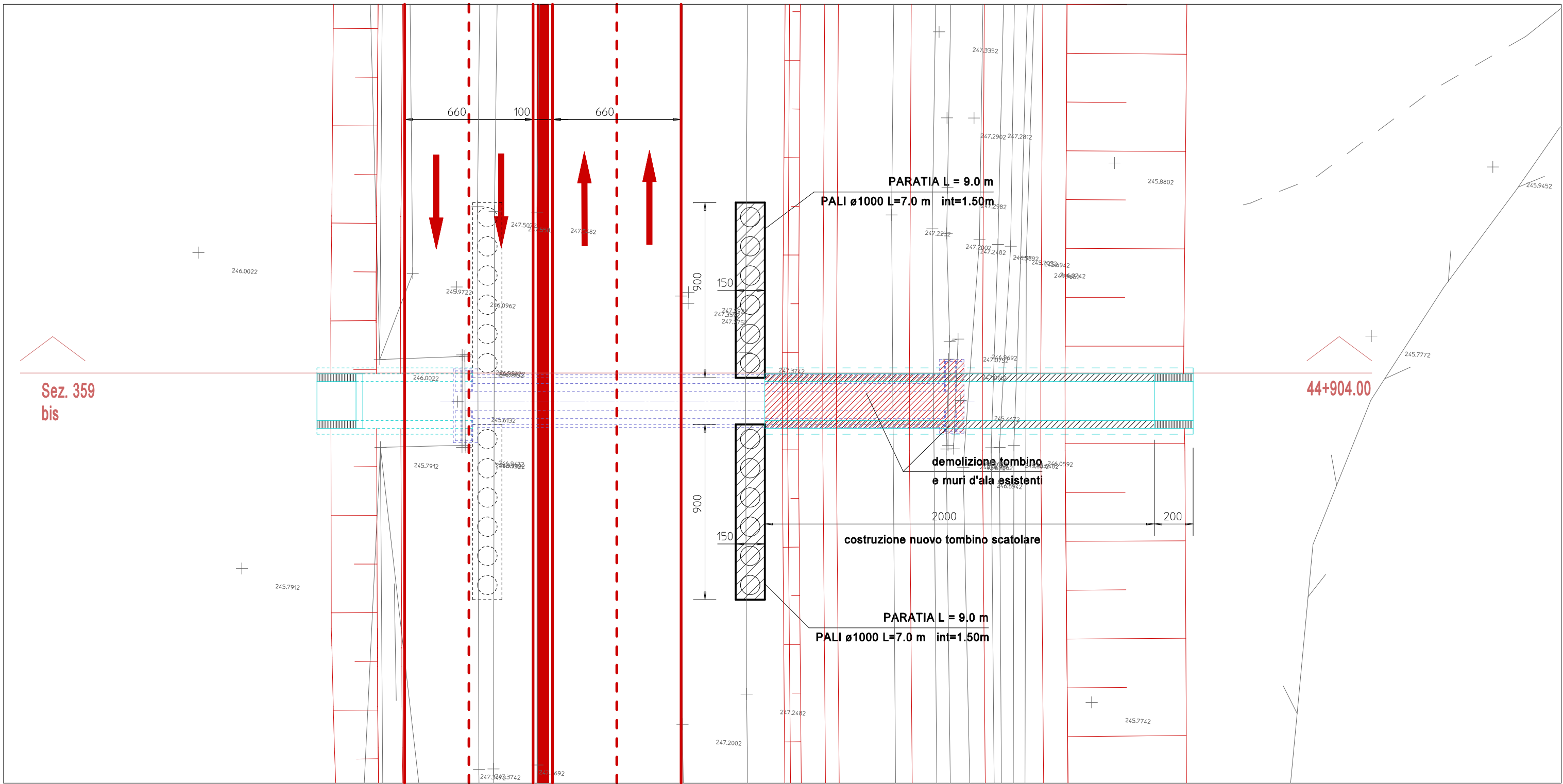

SEZIONE TIPO TOMBINO ESISTENTE

SCALA 1 : 100

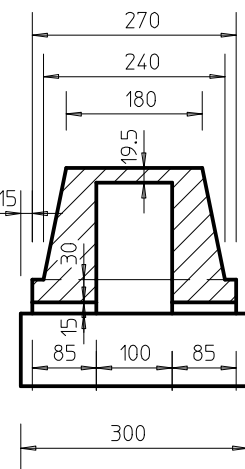

SEZIONE TRASVERSALE NUOVO SCATOLARE

SCALA 1 : 100

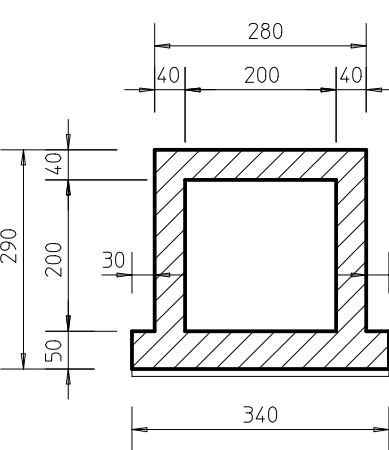

SEZIONE TRASVERSALE IMBocchi LATERALI

SCALA 1 : 100

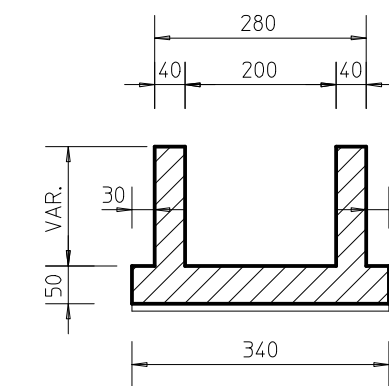

FASE 5

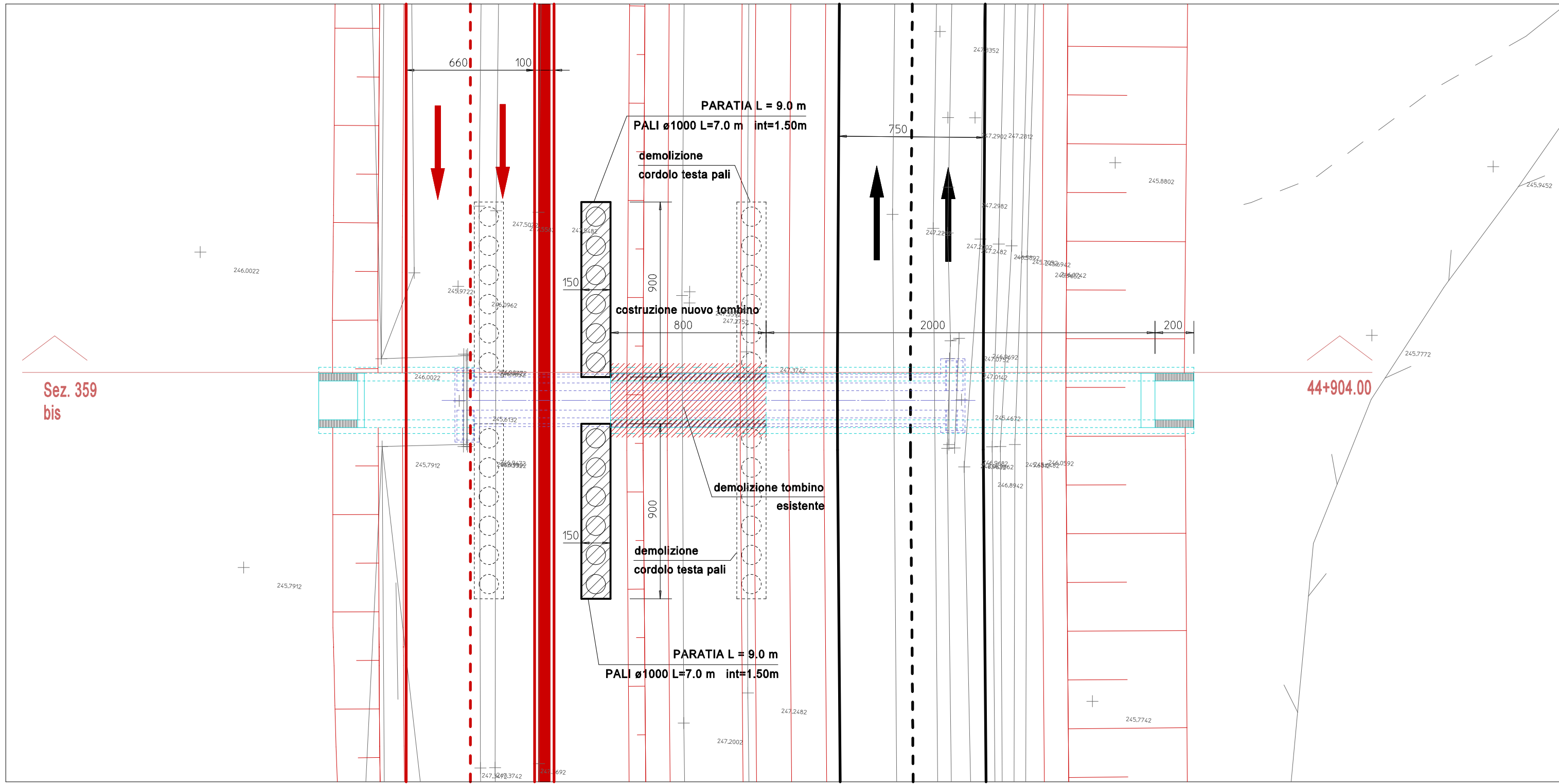

FASE 6

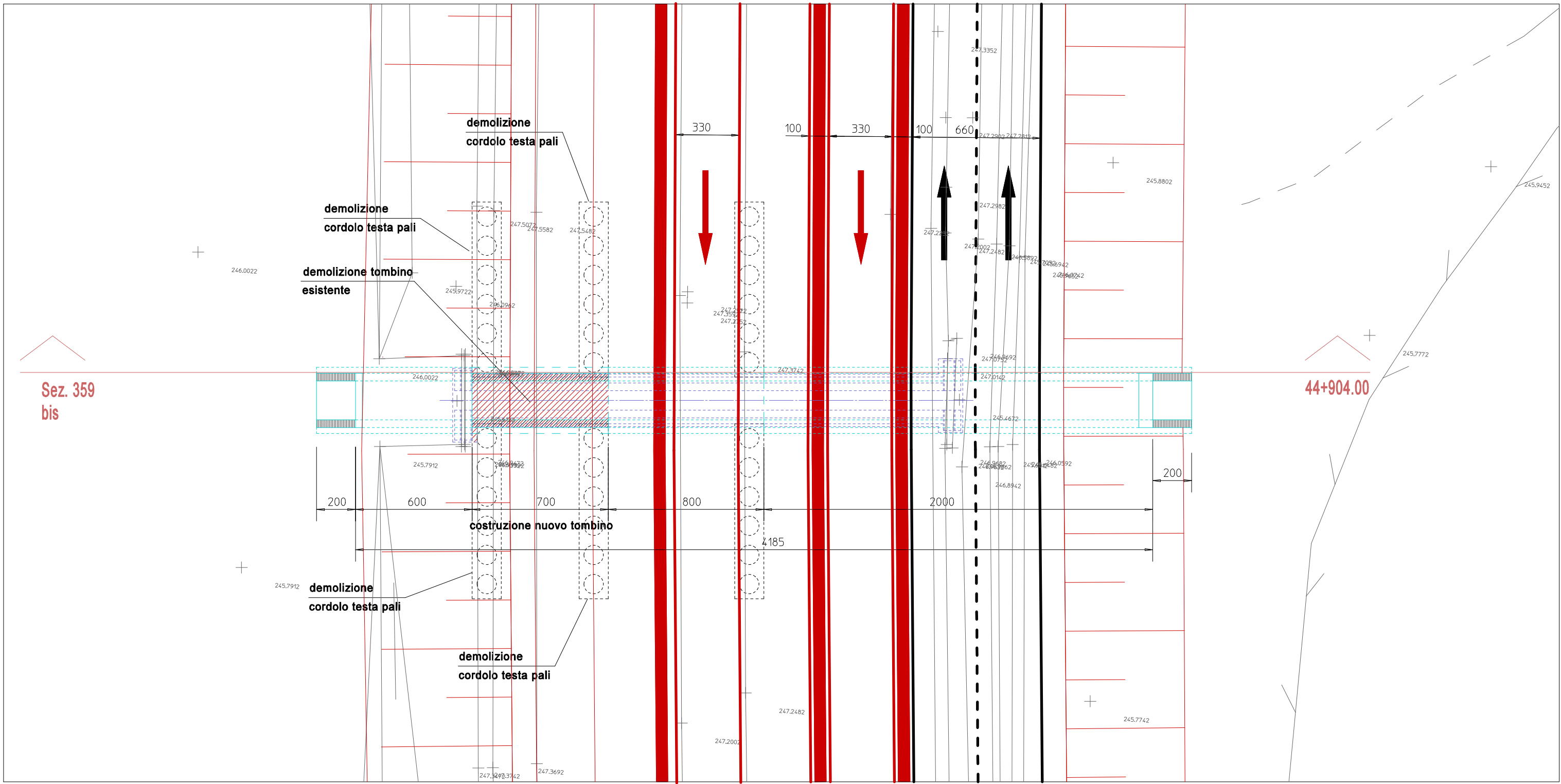

Sez. 359 bis
Q.Rif. : 235.00

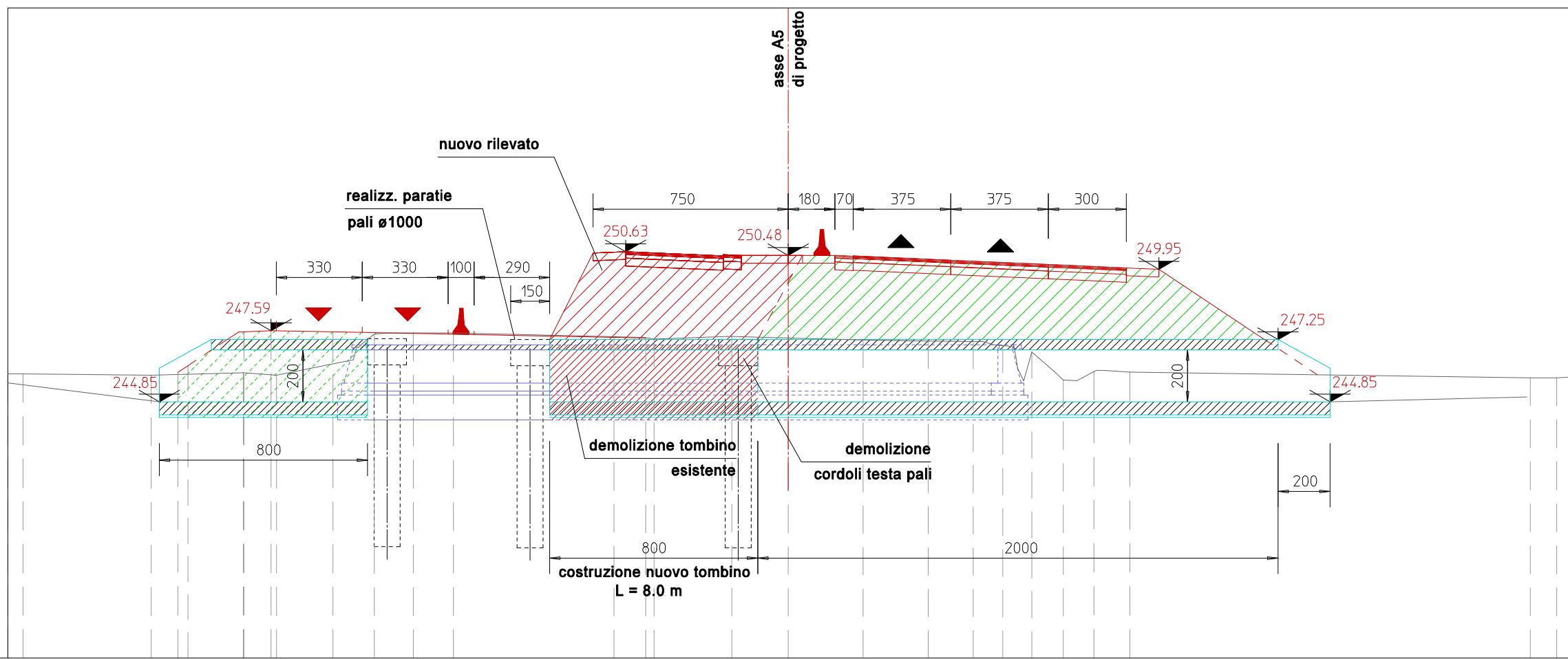

Sez. 359 bis
Q.Rif. : 235.00

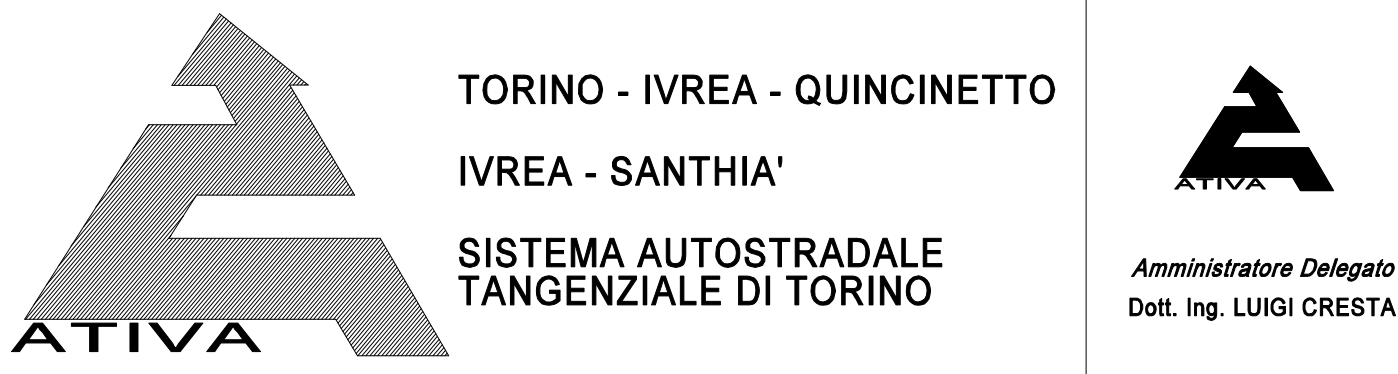
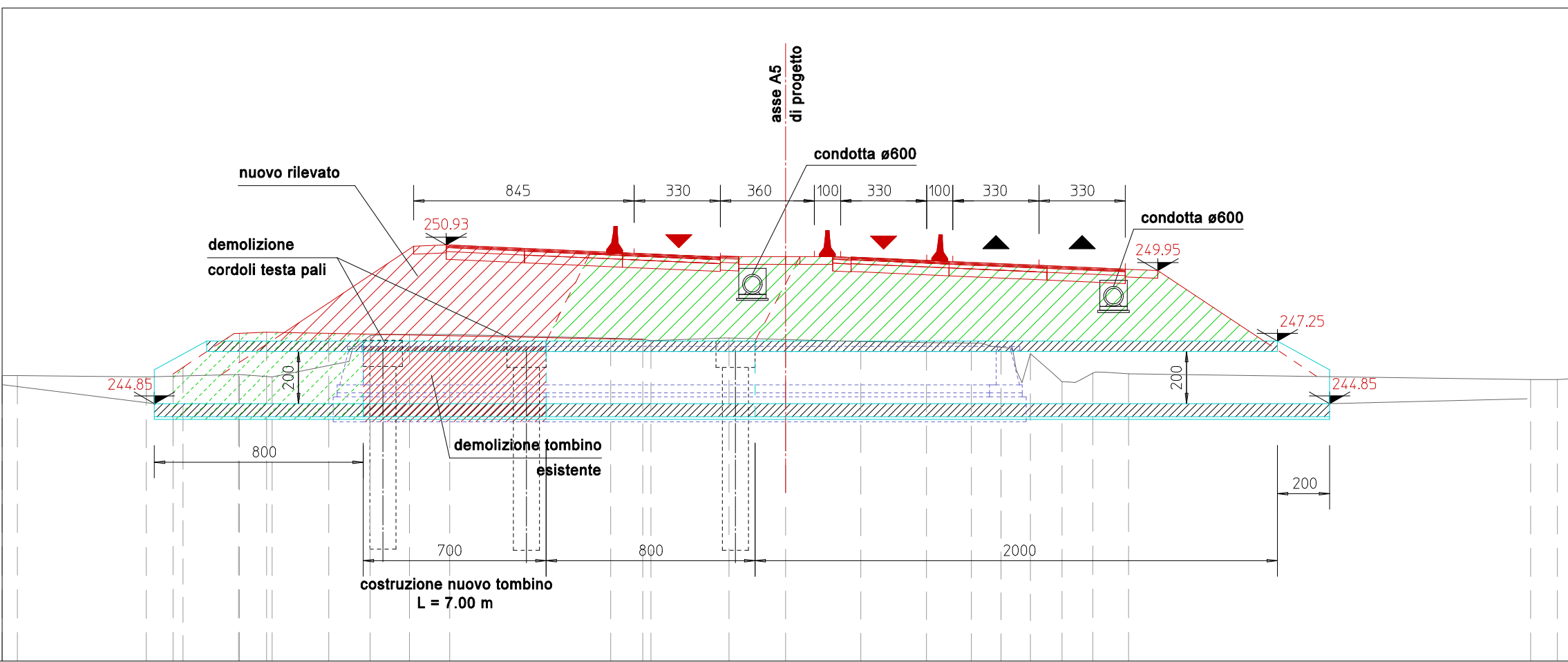

TORINO - IVREA - QUINCINETTO
IVREA - SANTHIA'
SISTEMA AUTOSTRADALE
TANGENZIALE DI TORINO

VISTO per FATMA S.p.A.

Amministratore Delegato
Dott. Ing. LUIGI CRESTA

**AUTOSTRADA A4/A5 - A5 TORINO QUINCINETTO
IVREA SANTHIA'**

**NODO IDRAULICO DI IVREA
2° FASE DI COMPLETAMENTO**

PROGETTO DEFINITIVO

**PARTE STRUTTURALE - OPERE MINORI
TOMBINO SCATOLARE AL km 44+904
DISEGNO D'INSIEME**

IL PROGETTISTA	REDATTO	CONTROLLATO	APPROVATO
ATA ENGINEERING	IGEAS P. Einaudi	IGEAS M. Barale	ATIVA ENGINEERING V. Palmisano
DATA	GIUGNO 2012	REVISIONE	DATA
SCALA	1 : 200		
Il Direttore Tecnico Dott. Ing. ROBERTO PETRALI ordine degli Ingegneri di Milano n° 14638	UFFICIO	COMESBA	W. PROG.
	SSP0101A0500PDSTR50500		